



# SMITH & WESSON



MODEL 34 — .22/32 KIT GUN®

MODEL 35 — .22/32 TARGET

PARTS LIST • INSTRUCTIONS FOR USE • MAINTENANCE

## SPECIFICATIONS



MODEL 34



MODEL 35

## SPECIFICATIONS

<b>Caliber</b> .....	.22 L. R.		
<b>Number of Shots</b> .....	6		
<b>Barrel</b> .....	M34 — 2", 4" M35 — 6"		
<b>Length Overall</b> .....	M34 with 4" barrel - 8" M35 with 6" barrel - 10½"		
<b>Weight</b> .....	M34 with 4" barrel and round butt, 22½ oz. M35 with 6" barrel and square butt, 25 oz.		
<b>Sights</b> .....	Front: M34 1/10" serrated ramp. M35 1/10" Patridge. Rear: S&W Micrometer Click sight, adjustable		for windage and elevation on both models.
		<b>Frame</b> .....	M34 Round or Square butt. M35 Square butt only.
		<b>Stocks</b> .....	Checked walnut Service with S&W Monograms
		<b>Finish</b> .....	M34 S&W blue or nickel. M35 Blue only.
		<b>Trigger</b> .....	S&W grooving.
		<b>Ammunition</b> .....	22 R. F. Short, Long, or Long Rifle cartridge.

# SMITH & WESSON

A BANGOR PUNTA COMPANY

Springfield, Massachusetts, U. S. A.

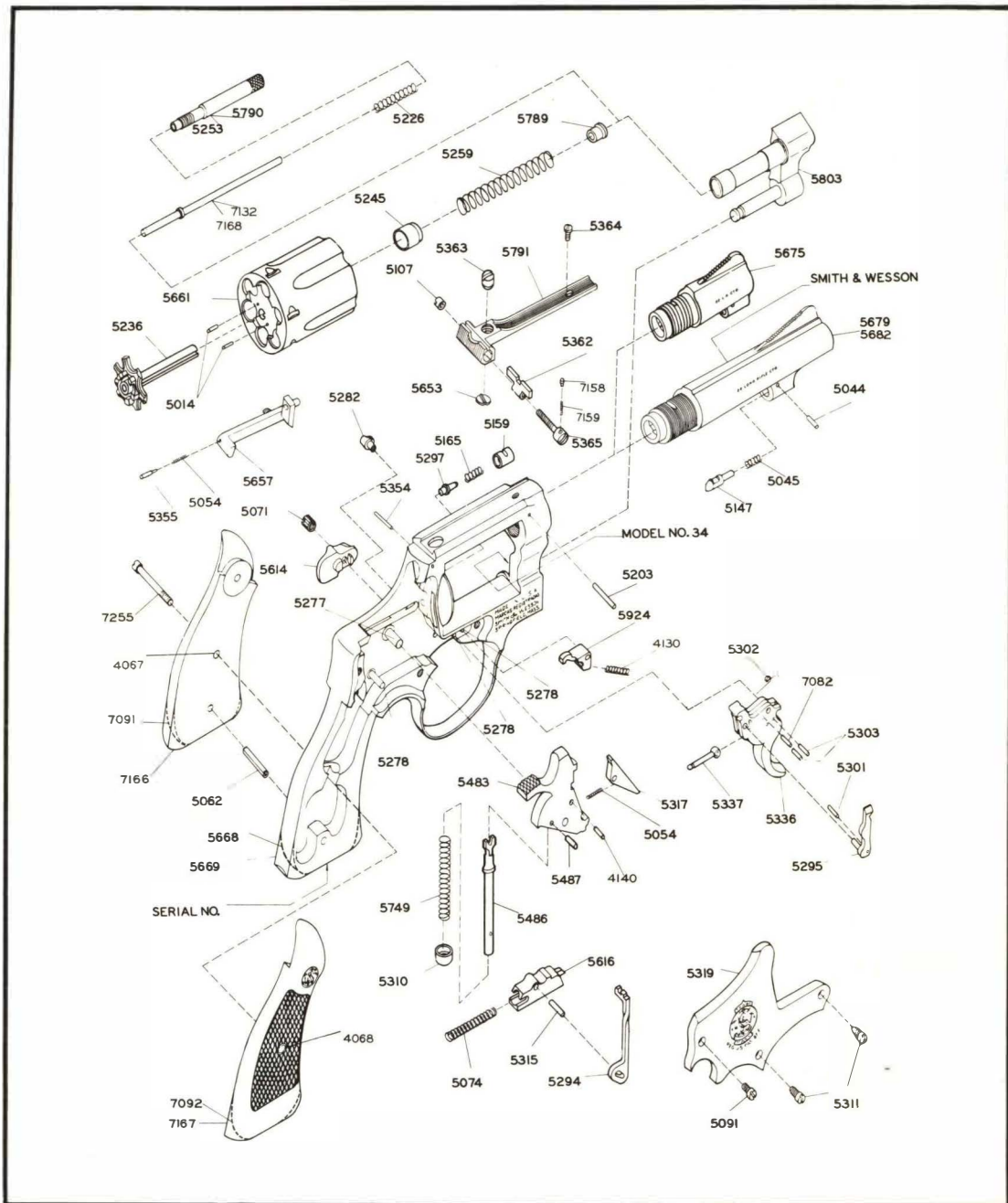

This schematic diagram and parts list conform to the current specifications provided by our Engineering Department. From time to time improvements are made in all our models. For this reason, the gun which you own may not correspond exactly with the information provided on this sheet. When requesting information or ordering parts for your gun, please provide the serial number and approximate date of purchase. 1.1-74

### Function

The Smith & Wesson Model 34 or 35 revolver is a 6-shot breech-loading hand weapon. It is produced with a solid frame and a swing-out type of cylinder, having 6 chambers around a central axis so that 6 shots may be fired before reloading is necessary. The weapon may be fired either single action or double action, and cocking the hammer by either method causes the cylinder to rotate and align the next chamber with the barrel. The rate of fire is limited only by the dexterity of the operator in reloading the cylinder and his ability to aim the weapon and pull the trigger.

Loading and firing this revolver is a comparatively simple operation, as follows:

Push the thumbpiece forward. This will release the cylinder so that it may be swung out to the left side for loading. Holding the gun so that the cylinder is in its outermost position, and with the muzzle pointing downward, insert cartridges in the charge holes making certain that they are firmly seated. Return the cylinder to its original position in the frame, pressing it firmly into place to make sure that it locks in alignment. The gun is now ready to fire.

In single action shooting the hammer is pulled or cocked to its extreme rearward position. The gun may then be fired by merely pressing the trigger. This type of shooting is used for deliberate fire where there is time to sight the gun carefully and squeeze the trigger in an unhurried fashion. It is also used in competitive shooting for not only slow fire but also for timed fire, whereby 20 seconds are allowed for the firing of each 5 shots, and rapid fire where 10 seconds are allowed for the firing of each 5 shots.

There is time even in rapid fire shooting for the deliberate handling of the gun in single action fashion just so long as the function is performed without loss of time and in a definite cadence whereby the cycle will be completed within the allocated time.

Where time or other circumstances do not allow for single action fire the revolver is used double action. To fire double action all that is necessary is to align the weapon with the object which you wish to hit and pull the trigger firmly all of the way to the rear. This will cause the hammer to rise to its full cocked position and then fall to fire the cartridge, and as previously stated the only limit to the speed with which a weapon can be manipulated in this fashion will be determined by the dexterity of the shooter. This type of shooting is required in combat work or under emergency conditions where the gun must be used with great speed.

To extract the fired cases press the thumbpiece forward and swing the cylinder out to the left side. Turn the gun muzzle upward and holding the cylinder in its extreme outward position press down sharply on the extractor rod. This will eject the fired cases down and out of the gun, which is now ready to reload.

## PARTS LIST

No.	Name	No.	Name
4067	Escutcheon .....	5319 *	Side Plate .....
4068	Escutcheon Nut .....	5336	Trigger .....
4069	Rear Sight Slide, 6" bbl. (M35) .....	5337	Trigger Lever .....
4079	Rear Sight Assembly, 6" bbl. (M 35) .....	5354	Firing Pin Bushing Pin .....
4130	Cylinder Stop Spring .....	5355	Bolt Plunger .....
4140	Sear Pin .....	5362	Rear Sight Slide 2" & 4" bbl. ....
5014	Extractor Pin .....	5363	Rear Sight Elevation Screw .....
5044	Locking Bolt Pin .....	5364	Rear Sight Leaf Screw .....
5045	Locking Bolt Spring .....	5365	Rear Sight Windage Screw .....
5054	Bolt Plunger Spring .....	5483	Hammer .....
5054	Sear Spring .....	5486	Mainspring stirrup .....
5062	Stock Pin .....	5487	Stirrup Pin .....
5071	Thumbpiece Nut .....	5614	Thumbpiece .....
5074	Rebound Slide Spring .....	5616	Rebound Slide .....
5091	Plate Screw, flat head .....	5653	Rear Sight Elevation Click Plug ....
5107	Rear Sight Windage Nut .....	5657	Bolt .....
5147	Locking Bolt .....	5661	Cylinder, with extractor, pins and gas ring .....
5159	Firing Pin Bushing .....	5668 *	Frame, with studs, bushing and lug (round)
5165	Firing Pin Spring .....	5669 *	Frame, with studs, bushing and lug (square)
5203	Barrel Pin .....	5675	Barrel, 2" .....
5226	Center Pin Spring .....	5679	Barrel, 4" .....
5236 *	Extractor .....	5682	Barrel, 6" .....
5245	Gas Ring .....	5749	Mainspring .....
5253	Extractor Rod for 2" barrels .....	5789	Extractor Rod Collar .....
5259	Extractor Spring .....	5790	Extractor Rod for 4" & 6" bbl. ....
5277	Hammer Stud .....	5791	Rear Sight Leaf .....
5278	Cylinder Stop Stud .....	5792	Rear Sight Assembly 2" & 4" bbl. ..
5278	Rebound Slide Stud .....	5803 *	Yoke .....
5278	Trigger Stud .....	5924	Cylinder Stop .....
5282	Frame Lug .....	7082	Hand Spring Pin .....
5294	Hammer Block .....	7091	Stock, left hand, round .....
5295	Hand .....	7092	Stock, right hand, round .....
5297	Firing Pin .....	7132	Center Pin for 4" barrels .....
5301	Hand Pin .....	7158	Rear Sight Plunger .....
5302	Hand Spring .....	7159	Rear Sight Plunger Spring .....
5303	Hand Torsion Spring Pin .....	7166	Stock, left hand, square .....
5303	Trigger Lever Pin .....	7167	Stock, right hand, square .....
5310	Mainspring Swivel .....	7168	Center Pin for 2" barrels .....
5311	Plate Screw, crowned .....	7255	Stock Screw .....
5315	Rebound Slide Pin .....		
5317	Sear .....		

\* (factory exchange only)

Smith & Wesson will refinish handguns of its own manufacture. No change of finish is offered on the Victory or Airweight® model or on Models 28, 39, 59, 64, 65, 66 or 67. Repair or replacement of parts are in addition to refinishing price.

### SERVICE

Should your Smith & Wesson revolver require adjustment, repair, or refinishing, we recommend most sincerely that the weapon be returned to the factory or authorized service center. There is no other way to insure that the work will be done in a properly equipped and staffed shop.

Charges are very reasonable, being based on the cost of parts replaced plus a labor charge for the time expended on the job. A labor charge for one hour is usually sufficient to cover all but very extensive overhaul jobs.

Revolvers returned to the factory or authorized service center should be MARKED FOR THE ATTENTION OF THE SERVICE DEPARTMENT.

A letter of instructions should be enclosed with the gun, and shipment by individuals must be made Prepaid. Adherence to these suggestions will prevent loss of time in handling at the factory.

When returning guns for service, please remove custom stocks and holsters. We cannot assume responsibility for these items.

When your revolver arrives for service, it will be very carefully inspected, together with your letter of instructions. Next, a quotation covering total cost of work to be performed will be sent to you. No actual work will be commenced before receiving your approval of our quotation unless you specifically authorize us to do so.

**SEE YOUR AUTHORIZED SMITH & WESSON  
SERVICE CENTERS LIST FOR YOUR LOCAL SERVICE CENTER**

## HELPFUL HINTS

1. Push thumb piece forward, swing out cylinder and load.
2. Close cylinder and take position on firing line.
3. **STAND** in a relaxed and comfortable position, feet well apart. The arm when raised should line naturally with the target. If it does not, shift the feet a bit.
4. **HOLD** the gun firmly but do not seize it with a "death grip". If the knuckles are white, the grip is too tight.



5. **LINE** the sights carefully, top of front sight even with top of rear notch, and light equal on both sides of front sight (see illustration).

6. **SQUEEZE** the trigger with trigger finger only, carefully keeping the sights aligned on the target. **SQUEEZE** is the most important function

of shooting. A pull or yank on the trigger will surely disturb alignment and result in a poorly placed shot or a complete miss. **DO NOT** apply the **SQUEEZE** with the whole hand. The squeeze should be applied between the tip and first joint of the trigger finger. Slowly at first — speed will develop with practice.

7. Watch the sights. Learn to "call your shots" before looking for them on the target. Practice "dry shooting" with empty gun. Watch sights when hammer falls. If sights jump or duck you are not squeezing the trigger. Don't hold the shot too long. If the sights don't line up on the target in 15 seconds, take the arm down and rest for a moment. Remember, good revolver shots are not born; they are made by careful and consistent practice.

## SIGHT ADJUSTMENT

1. Front sight is fixed. All adjustments must be made at the rear sight.
2. Move the rear sight in the direction in which you wish the group on the target to move. (If group must be higher, elevate the rear sight. If group must go to the right, move the rear sight to the right, etc.)
3. To elevate rear sight turn top (elevating) screw to the left, or counterclockwise. To depress rear sight turn top (elevating) screw to the right, or clockwise.
4. To move rear sight to right, turn side (windage) screw to the right, or clockwise. To move rear sight to left, turn side (windage) screw to the left, or counterclockwise.

## INSTRUCTIONS FOR USE

### Care and Cleaning

Many weapons require stripping or at least partial disassembly in order to clean and oil them properly. This does not apply to the revolver, which may be cleaned and lubricated under all normal circumstances without removing a single pin or screw.

If at any time disassembly of the weapon is indicated for repairs, etc. it is recommended that the gun be returned to the factory, or you should at least employ the services of a qualified gunsmith.

To keep revolvers in proper condition, and to insure perfect functioning in time of need, it is essential that they be kept clean and coated with a rust inhibiting oil. Care is required to prevent rust, especially in damp, humid climates, or when sweaty hands come in contact with the guns.

To clean the revolver as required when the weapon is not fired, or when kept in storage, rub it externally with a lightly oiled cloth, and then swab out the bore and cylinder chambers with an oily flannel patch. Remove excess oil but leave a light film to protect the arm against rusting. Clean out all crevices with a small clean brush.

For cleaning after firing, scrub out the bore and chambers with an approved nitro solvent, and

then use a brush dipped in solvent to remove all deposits from around the breech of the barrel, extractor head, and other adjacent areas which have been subjected to the action of powder or primer residue. If there is any evidence of lead particles, or other foreign matter left in bore or chambers, it is well to scrub these parts further with a bronze or brass brush dipped in powder solvent. The area under the extractor should be cleaned frequently and kept dry, as an accumulation of powder residue can cause the cylinder to bind.

After cleaning off the entire gun with nitro or powder solvent, remove all traces of the solvent, both on the exterior of the gun and in the bore and chambers, following immediately thereafter with the application of a light film of oil. Note that there is usually some residue in the steel of both barrel and cylinder that works out and becomes apparent within from 24 hours to 48 hours after the initial cleaning. This can be removed with a bristle brush with perhaps a light re-application of powder solvent, after which the oil film should be re-established on all surfaces.

Do not store revolvers with a plug in the barrel, since this is a contributing factor to sweating. By the same token, maintenance or storage rooms should be kept at a constant temperature with the least possible humidity, and the guns should *not* be stored encased in anything which will attract or hold moisture, such as leather.

If revolvers are to be stored for a long period of time, the internal mechanism of the lockwork should be heavily oiled with an acid free lubricating oil, and the exterior of the guns, as well as the bore of the barrel and the charge holes of the cylinder, should be heavily coated with an anti-rust oil. It is an established fact that moisture is the greatest enemy of metallic objects, particularly in climates where temperature and humidity are high, and salt air is present. Extreme care should be exercised that all metallic surfaces be kept clean and oiled, and the wood stocks on the revolvers should be inspected for cracks caused by moisture. A periodical coat of raw linseed oil, well rubbed in with the hand, will help to prevent the splitting of stocks, but care must be exercised that the linseed oil does not get into the mechanism or on moving parts, as it has a tendency to gum when dry.

### Safety Precautions

Before proceeding to use this weapon, a word of caution is in order. This gun is as safe to handle and use as we can make it, but there is no foolproof firearm. Used correctly by a competent person the revolver is one of the safest handguns. There are many safety rules but those found below are basic, and should be observed rigidly until they become second nature.

1. The gun must always be checked for live ammunition when picked up, drawn from the holster, or handed to or accepted from another individual.

2. The gun should always be holstered except when drawn for a definite purpose.

3. Never point the revolver at anything that you do not intend to shoot.

4. Do not cock the gun unless you intend to shoot it. Do not even insert the finger in the trigger guard until you are ready to fire.

5. Dry-snapping, even with dummy cartridges, should be discouraged unless same is performed on a regular target range or at a known inanimate target object.

6. When the handgun is out of the holster and held in a ready position, be absolutely certain that it is not pointing at any part of yourself or the persons of others who are in your immediate vicinity.

7. Beware of obstructions in the barrel. If, when firing, a weak or peculiar report is heard, cease firing at once and inspect the barrel for an obstruction. A stuck bullet, or any other object in the barrel, should be removed immediately, since even a plug of mud, snow, twigs, or an abnormal quantity of heavy grease in the bore, may result in a bulged or burst barrel.

8. At all times treat the revolver as the precision instrument that it actually is.

### MAKE SAFE GUN HANDLING A HABIT